

## GTF-40.5/1250-20

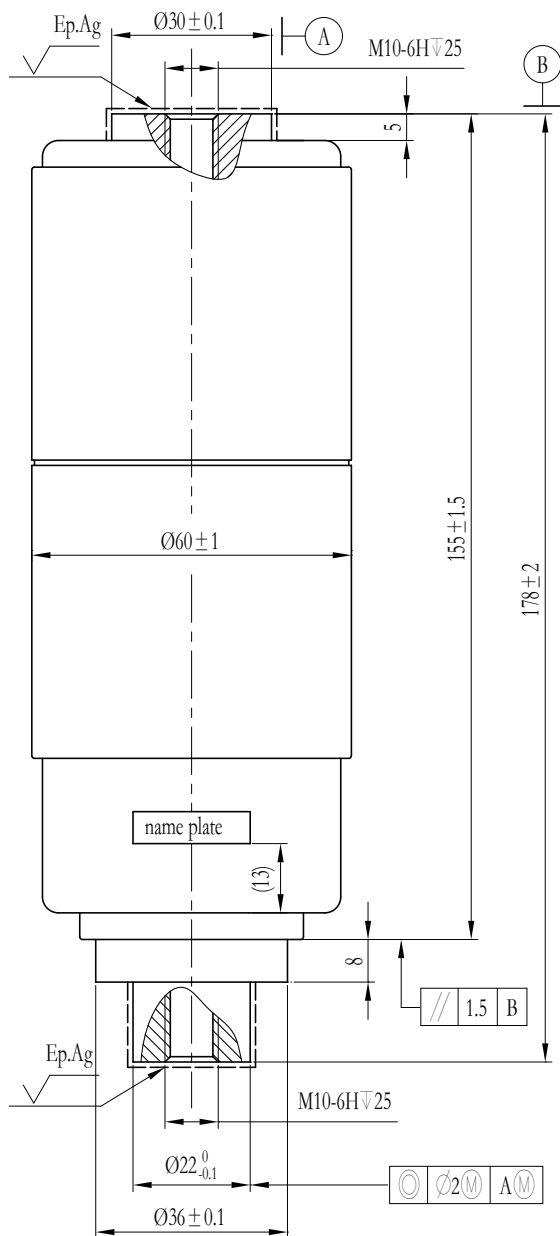

### Main Technical Data

Item	Unit	Value
Rated Voltage	kV	40.5
Lightning Impulse Withstand Voltage (Peak)	kV	—
Short-time (1min) Power-frequency Withstand Voltage	kV	35/60☆
Rated Frequency	Hz	60
Rated Current	A	1250
Rated Short-time Withstand Current	kA	20
Rated Duration of Short-circuit	s	4
Rated Peak Withstand Current	kA	—
Rated Short-circuit Making Current	kA	—
Rated Active Load Breaking Current	A	1250
Rated Closed-loop Breaking Current	A	1250
Rated Single Capacitor Bank Breaking Current	A	400※
Rated Back-to-Back Capacitor Bank Breaking Current	A	400※
Rated Breaking Current of Cable Charging	A	21
Mechanical Endurance	Operations	10000
Clearance Between Open Contacts	mm	15±1
Contact Closed Force Due to Bellows and Atmosphere	N	70±20
Counterforce of Contact at Full Stroke	N	140±20
Circuit Resistance at Min. Rated Contact Force	μΩ	≤30
Contact Limit Erosion	mm	3
Mass of Moving Parts	kg	0.4
Internal Gas Pressure	Pa	<1.33×10 <sup>3</sup>
Shelf Life	Years	20

### Mechanical Data of Switch Equipped With Interrupter

Item	Unit	Value
Average Opening Speed	m/s	1.0±0.2
Average Closing Speed	m/s	0.6±0.2
Contact Bounce Duration at Closing Operation	ms	≤3
Out of Simultaneity of Contact Closing and Opening	ms	≤1
Rated Contact Pressure	N	900 <sub>0</sub> <sup>200</sup>
Max. Rebound of Contact at Opening Operation	mm	3
Overtravel During Opening	mm	≤3

Note 1: “☆” Within transformer oil or equivalent isolation medium;

Note 2: “※” Rated characteristics to be given on request;

Note 3: Meets or exceeds the electrical endurance requirements of class E1 for autoreclosing duty per IEC 60265-1;

Note 4: The movable stem of the vacuum interrupter could not suffer twisting force and in order not to damage the metal bellows, the movable stem should be prevented from rotation when assembling. For more requirements please check the Instructions of Usage.