

## GTC-15/630-20A

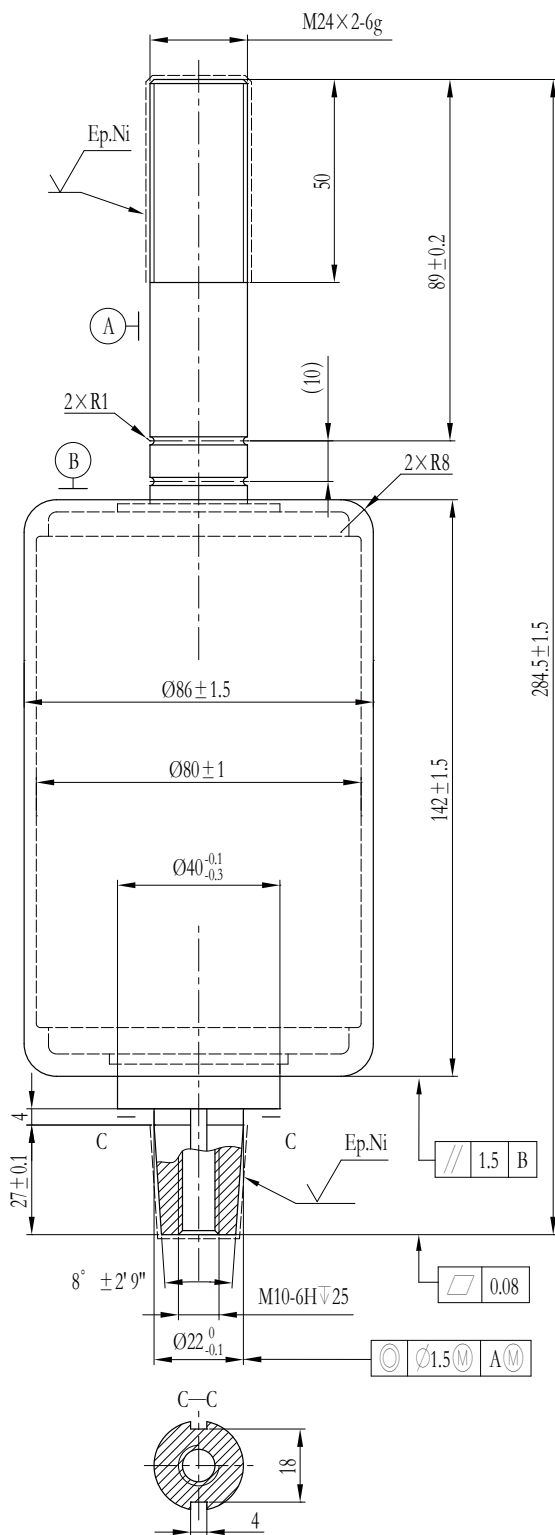

Main Technical Data		
Item	Unit	Value
Rated Voltage	kV	15
Lightning Impulse Withstand Voltage (Peak)	kV	100
Short-time (1min) Power-frequency Withstand Voltage	kV	60
Rated Frequency	Hz	50
Rated Current	A	630
Rated Short-time Withstand Current	kA	20
Rated Duration of Short-circuit	s	4
Rated Peak Withstand Current	kA	50
Rated Short-circuit Making Current	kA	50
Rated Short-circuit Breaking Current	kA	20
Rated Operating Voltage	kV	15
Mechanical Endurance	Operations	10000
Clearance Between Open Contacts	mm	9±1
Contact Closed Force Due to Bellows and Atmosphere	N	80±25
Counterforce of Contact at Full Stroke	N	140±30
Circuit Resistance at Min. Rated Contact Force	μΩ	≤25
Contact Limit Erosion	mm	3
Mass of Moving Parts	kg	0.6
Internal Gas Pressure	Pa	<math><1.33 \times 10^{-3}</math>
Shelf Life	Years	20
Rated Operating Sequence :	O-t1-CO-t2-CO-t3-CO-Lockout	
Min. Rated Starting Current(error ≤ ±10%) :	Hydraulic Pressure Control: it is twice as large as the rated current of series coil. Electron Control: it is adjustable.	

Mechanical Data of Switch Equipped With Interrupter		
Item	Unit	Value
Average Opening Speed	m/s	1.1±0.2
Average Closing Speed	m/s	0.6±0.2
Contact Bounce Duration at Closing Operation	ms	≤3
Out of Simultaneity of Contact Closing and Opening	ms	≤1
Rated Contact Pressure	N	1800 <sup>+200</sup> <sub>0</sub>
Contact Pressure at Contact Touch Point	N	1300 <sup>+200</sup> <sub>0</sub>
Max. Rebound of Contact at Opening Operation	mm	2
Overtravel During Opening	mm	≤2

Note : Meets or exceeds the electrical endurance requirements of class E2 for autoreclosing duty per IEC 62271-100 .